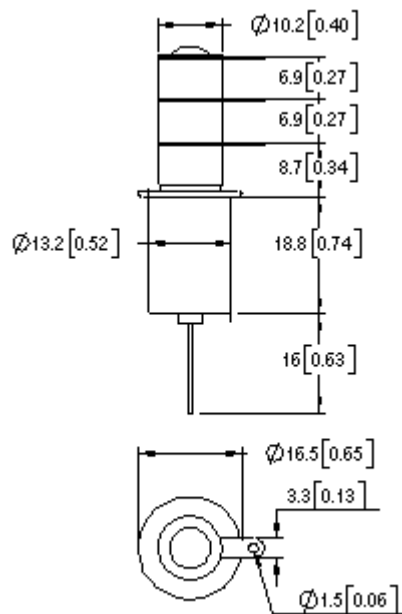

G45C**5 kV**

Make & Break Load Switching

RoHS Compliant, date code 0601 and later

**FEATURES**

- Smallest size double throw, 5 kV, RF rated relay with it's current ratings
- Very low profile, even when wires connected
- Vacuum dielectric for low current power switching
- Low coil power
- Meets or exceeds MIL-R-83725

See [Mounting & Coil Terminations](#) for additional Options

PRODUCT SPECIFICATIONS

Contact & Relay Ratings	Units	G45C
Contact Form		C
Contact Arrangement		SPDT
Voltage, Test Max., Contacts & to Base (15 μ A Leakage Max., dc or 60Hz)	kV Peak	6
Voltage, Operating Max., Contacts & to Base (15 μ A Leakage Max.)		
dc or 60 Hz	kV Peak	5
2.5 MHz	kV Peak	4.5
16 MHz	kV Peak	3.5
32 MHz	kV Peak	2.8
Current, Continuous Carry Max		
dc or 60 Hz	Amps	20
2.5 MHz	Amps	16
16 MHz	Amps	10
32 MHz	Amps	8
Coil Hi-Pot (V RMS, 60 Hz)	V	500
Capacitance		
Across Open Contacts	pF	1.6
Contacts to Ground	pF	2
Resistance, Contact Max @ 1A, 28Vdc	ohms	0.05
Operate Time	ms	10
Release Time	ms	10
Life, Mechanical	cycles	2 million
Weight, Nominal	g (oz)	21 (0.75)
Vibration, Operating, Sine (10-2000 Hz Peak)	G's	10
Shock, Operating, 1/2 Sine 11ms (Peak)	G's	30
Temperature Ambient Operating	°C	-55 to +125

COIL RATINGS

Nominal, Volts dc	12	26.5
Pick-up, Volts dc, Max.	8	16
Drop-Out, Volts dc	.5 - 5	1 - 10
Coil Resistance (Ohms $\pm 10\%$)	230	920

Ratings listed are for 25°C, sea level conditions

For more information, refer to

[Relay User Instructions](#)

G45**C 3 3 4**

Contact Form
C = SPDT

Coil Voltage
2 = 12 Vdc, Bus Wire
3 = 26.5 Vdc, Bus Wire

High Voltage Connections
3 = Solder Connection

Mounting
2 = Flanged
4 = Standard

01/11/11

GIGAVAC®

GIGAVAC® - P.O. Box 4428 - Santa Barbara, CA 93140-4428 - ph +(805) 684-8401 - +(805) 755-2000
fx +(805) 684-8402 - info@gigavac.com - www.gigavac.com - ©Copyright 2003-2011 GIGAVAC, LLC.