

# 700VDC, DC Fuse for EV/HEV

## STEV3065 Series

### Description 描述

- DC fuse for EV/HEV 用于纯电动汽车和混合动力汽车的直流熔断器
- Stud-mount, optional for other installtion 螺栓安装,提供其他安装方式选择
- 700Vdc ideal for EV or HEV application 专为纯电动汽车和混合动力汽车设计的 700V 直流熔断器
- Excellent DC performance 卓越的直流分断能力
- Special designed fuse base for vehicle situation 提供专为汽车恶劣环境特殊定制的熔断器底座

Electrical Characteristics		
% of Ampere Rating (A)	Operating	
	Min	Max
200%	1	300
300%	0.2	30
500%	0.1	10

### Specifications 电气特性

Type	Ordering P/N	Electrical Characteristics		
类型	订购料号	Rated Current(Amp)	Interrupting rating	I <sup>2</sup> t (A <sup>2</sup> S)
单体 Single	STEV3065-50	50	700Vdc/10000A	3200
	STEV3065-60	60		5040
	STEV3065-70	70		6860
	STEV3065-80	80		8960
	STEV3065-90	90		11340
	STEV3065-100	100		14000
	STEV3065-125	125		23000
	STEV3065-150	150		31000
	STEV3065-175	175		40000
	STEV3065-200	200		52000

\*Temperature Rise 温升: <=45K with 60% of rated current 60%额定电流小于等于 45K

### Dimension (mm)尺寸

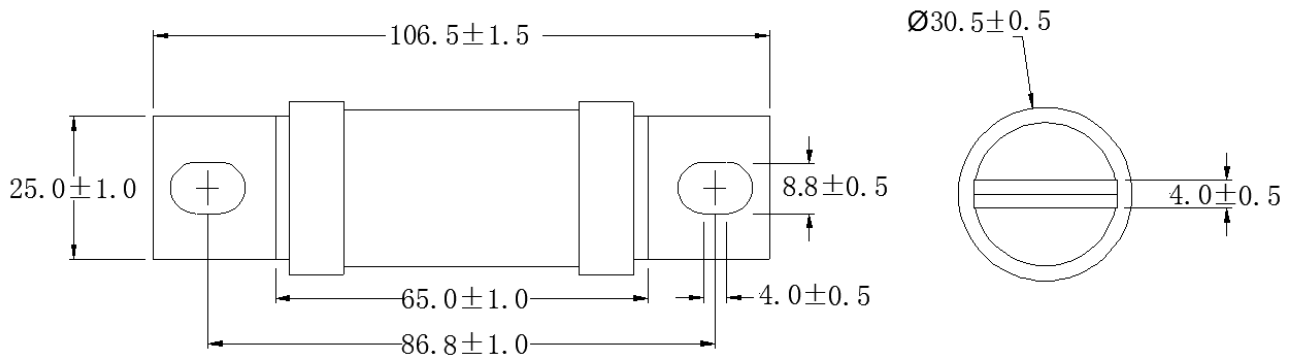

700VDC, DC Fuse for EV/HEV  
STEV3065 Series

Time-Current Curve 时间电流曲线

